

# ROTADAIRON®

# TR 130

SOIL PREPARER / MARKET GARDENING

WEEDING

RAKING

SOIL  
PREPARATION

SEEDING

OVERSEEDING

DEHATCHING -  
SPIKING

MULCHING

SPECIAL  
APPLICATIONS



MADE IN FRANCE

# SOIL PREPARER / MARKET GARDENING

## TR 130

### Functions of the stone burier TR 130

The TERRAGRO developed by ROTADAIRON in collaboration with the professionals of the horticultural and market gardening sector is a preparator-burrier for seedbeds or plantations, in beds or in forms. The TERRAGRO works the soil surface and respects its agronomic structure.

Its oversized rotor with reverse rotation throws stones, plant waste and soil against the selection grid, and, by densimetry, deposits the coarse elements which are then covered with fine soil.

The beds have, in all points, a perfect homogeneity of density which favors a more grouped germination of seeds and a faster recovery of the plants.

The TERRAGRO can thus work in all types of soil (sand, clay, silt, pebbles) while ensuring an ideal quality of preparation.

### Quality of service

A large stock of spare parts is permanently maintained at our factory. Our partners have online tools and quick access to manufacturer information.

Maintain the quality and performance of your Rotadairon® by using only original parts.

- 1 Oversized rotor
- 2 Anti-pad blades (Rotadairon® patent)
- 3 Selection grid fingers
- 4 Torque limiter with dry friction and flywheel
- 5 Soil preparation principle
- 6 Working depth adjustment
- 7 Forms creation principle
- 8 Grader blade
- 9 Option : Front discs

Machine	TR 130
Working width	1300 mm (51" 1/4)
Total width	1680 mm (66" 1/6)
Weight with mesh metal roller	800 Kg (1763 lb)
Tractor : Required power	35 - 60 CV
Tractor : Max track width	1.5 meters (59")
Working depth (max)	160 mm (6" 1/4)
Rotor outer diameter	400 mm (15" 3/4)
Depth adjustment	Support on rear roller adjustable by screw jacks
Number of blades	42
Grid finger spacing	35 mm (1" 3/8)
3 point hitch	Categories 1 & 2
PTO speed	540 tr/min
Tractor forward speed	0.8 to 1,5 Km/h (0.5 to 0.9 mph)
Transmission	Angle gearbox + Oil bath chain
Security	Torque limiter with dry friction and flywheel
Transport dimension w x L x H	1700mm x 2100mm x 1200mm (66" 4/5 x 82" 2/3 x 47" 1/4)
Option	Front discs

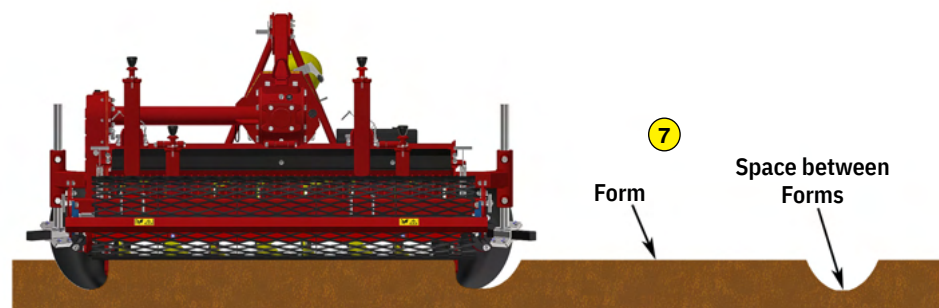
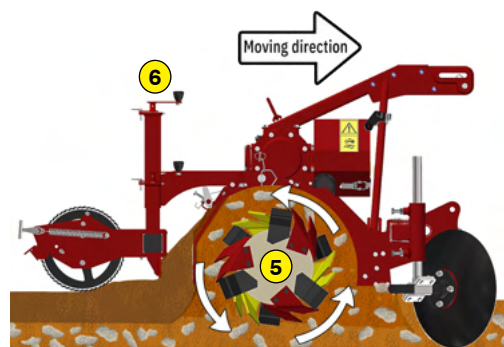
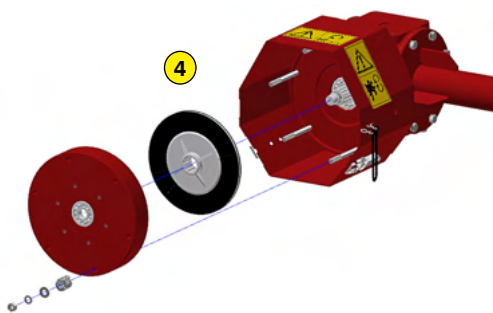
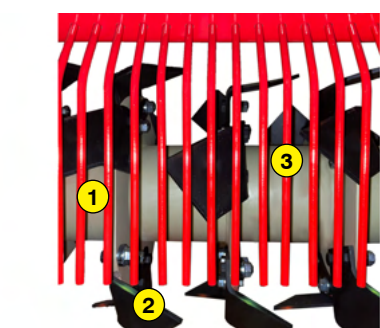

ROTADAIRON  
Départementale 92 - Les Hunaudières  
72230 Mulsanne - France  
Mail : [contacts@rotadairon.fr](mailto:contacts@rotadairon.fr)  
Phone number : (33) 2 43 422 422



[www.rotadairon.fr](http://www.rotadairon.fr)